



Steering Cable Installation Tool Kit



Models: T350, Speed Scrub 350

The Steering Cable Installation Tool Kit p/n 9016802 is required when installing or readjusting steering cables to ensure proper steering operation.

9016802 - Tool Kit Contents

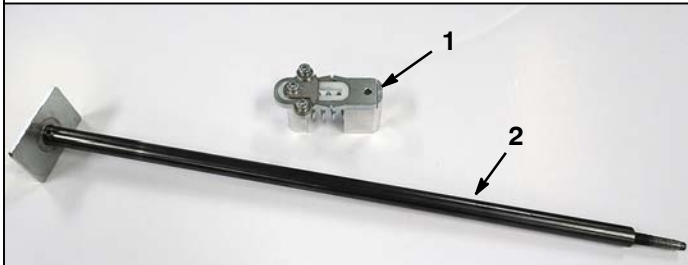

Ref	Part No.	Description	Qty.
1	1233471	Gauge, Tension, Cable	1
2	1234220	Tool, Alignment, Wheel	1

HOW TO USE THE STEERING CABLE INSTALLATION TOOL KIT:

1. Prepare machine for cable adjustment or cable installation:
 - a. Empty both the solution and recovery tanks.
 - b. Park machine on a level surface.
 - c. Lower the scrub head and remove key.
 - d. Remove squeegee assembly from machine.
 - e. Remove the front, right and left side frame shrouds from machine.
 - f. Remove batteries from machine.

FOR SAFETY: When handling batteries, wear protective gloves and eye protection. Avoid contact with battery acid.

- g. If replacing the steering cables, refer to the Service Manual for steering cable installation instructions.
2. On a non-marring surface, with assistance carefully lay the machine on its left side.
3. Remove the right front wheel and the hardware securing the drive wheel (Figure 1). Do not remove drive wheel.

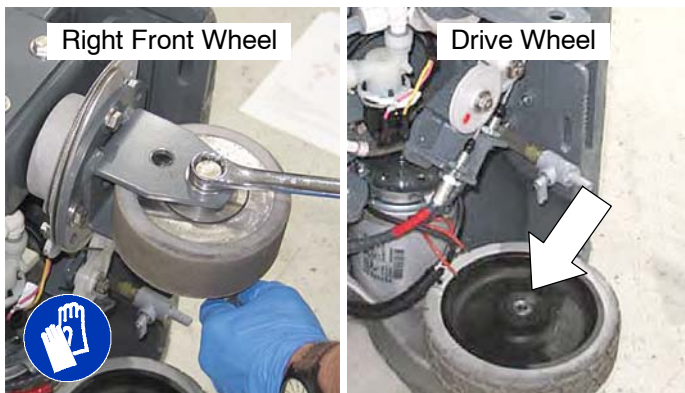

Fig. 1

4. Insert the wheel alignment tool through the right wheel bracket and thread it into the drive wheel as shown (Figure 2). Do not over tighten the wheel alignment tool.

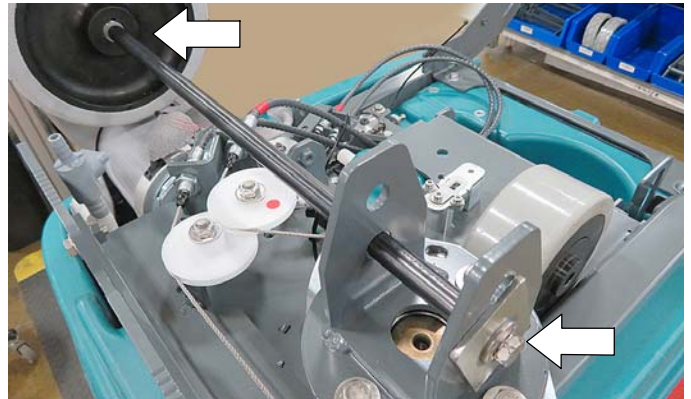

Fig. 2

5. Check the cable routing to ensure it's properly installed (Figure 3). Refer to Service Manual for further details.

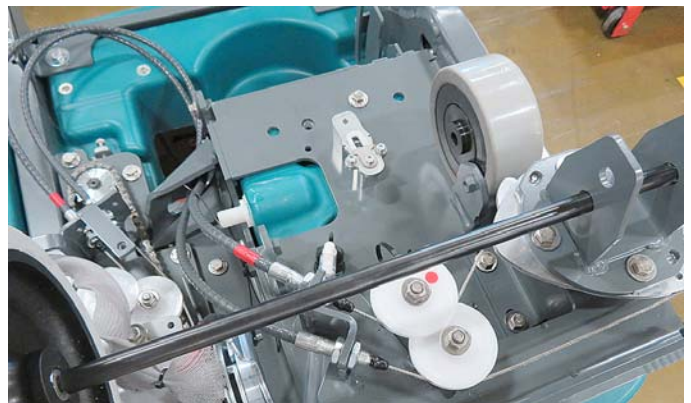

Fig. 3

6. Compress the tension gauge tool by hand and place it on the top steering cable as shown (Figure 4).



Fig. 4

7. Check the alignment on the tension gauge tool (Figure 5). The indicator points should align with the notches. If the indicator points do not align with the notches, cable tension adjustment is required.

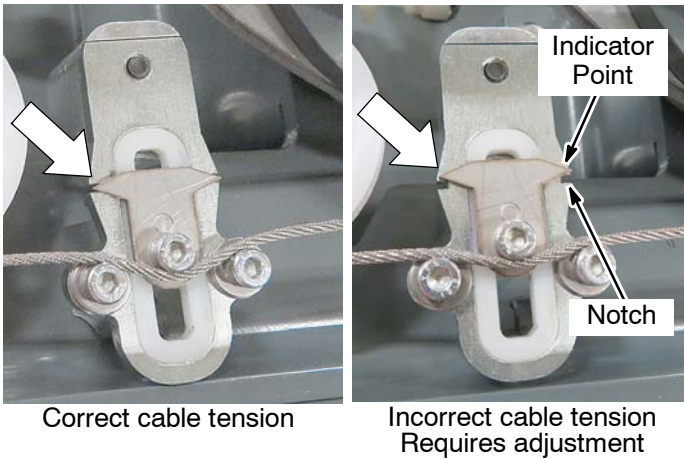

Fig. 5

8. To properly adjust the cable tension, loosen the jam nut on the cable and turn the adjustment nut until the indicator points line up with the notches (Figure 6). Turn the adjustment nut clockwise to tighten or counter-clockwise to loosen. Re-tighten jam nut.

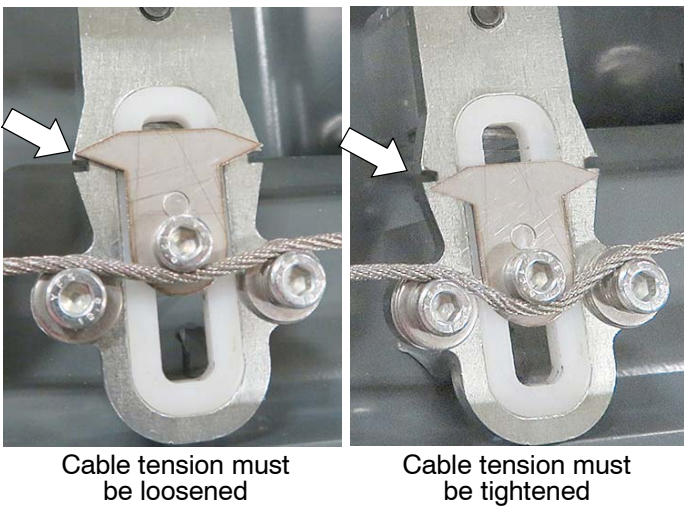
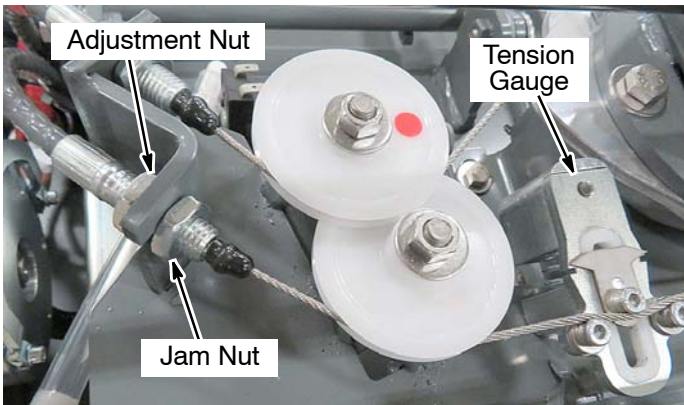

Fig. 6

9. Place the tension gauge tool on the bottom steering cable (red) and repeat the tension adjustment procedure (Figure 7).

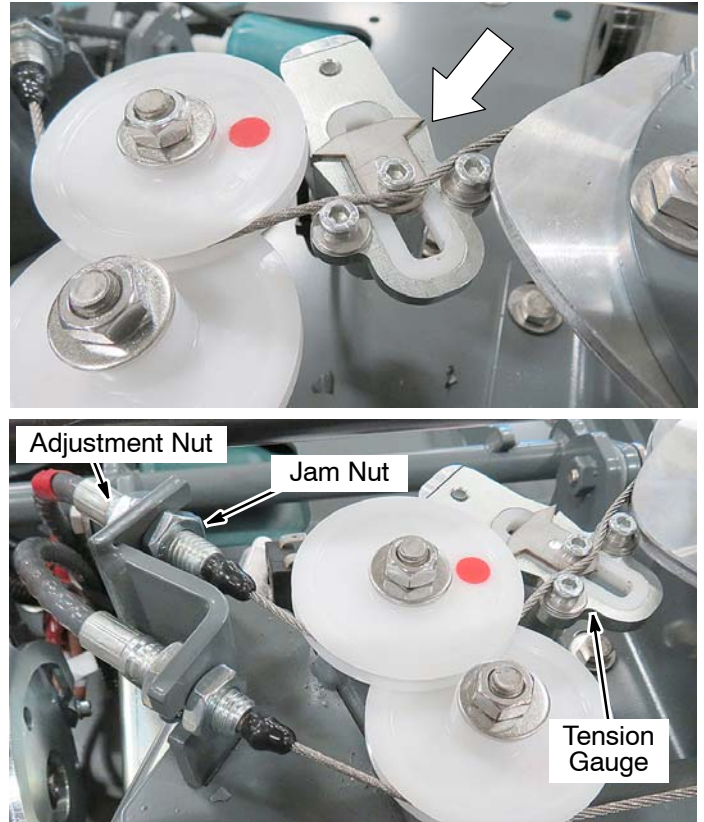

Fig. 7

10. Remove the tool kit from machine and re-install the drive wheel hardware and right front wheel.
11. Stand machine upright and reinstall the removed parts.
12. Test the machine for proper steering operation. Turn the steering wheel through the full range of motion in both directions while the machine is moving.

STEERING CABLE KIT:

Refer to the Service Manual for steering cable installation instructions.

9016803 - Steering Cable Kit Contents

Ref	Part No.	Description	Qty.
1	1231914	Cable, Steering, Top	1
2	1231915	Cable, Steering, Bottom, Red	1
3	1034731	Screw, Hex, M6x1.00x16 sems	2
4	44961	Tie, Cable, nyl, 14.5L .30w	1
5	1210807	Wire, Tie [w/.25 fir tree clip]	6
6	58979	Screw, Hex, M6x1.00x55, fl,ss	2

9016804 - Steering Cable and Tool Kit Contents

Ref	Part No.	Description	Qty.
1	1231914	Cable, Steering, Top	1
2	1231915	Cable, Steering, Bottom, Red	1
3	1034731	Screw, Hex, M6x1.00x16 sems	2
4	44961	Tie, Cable, nyl, 14.5L .30w	1
5	1210807	Wire, Tie [w/.25 fir tree clip]	6
6	58979	Screw, Hex, M6x1.00x55, fl,ss	2
7	1233471	Gauge, Tension, Cable	1
8	1234220	Tool, Alignment, Wheel	1

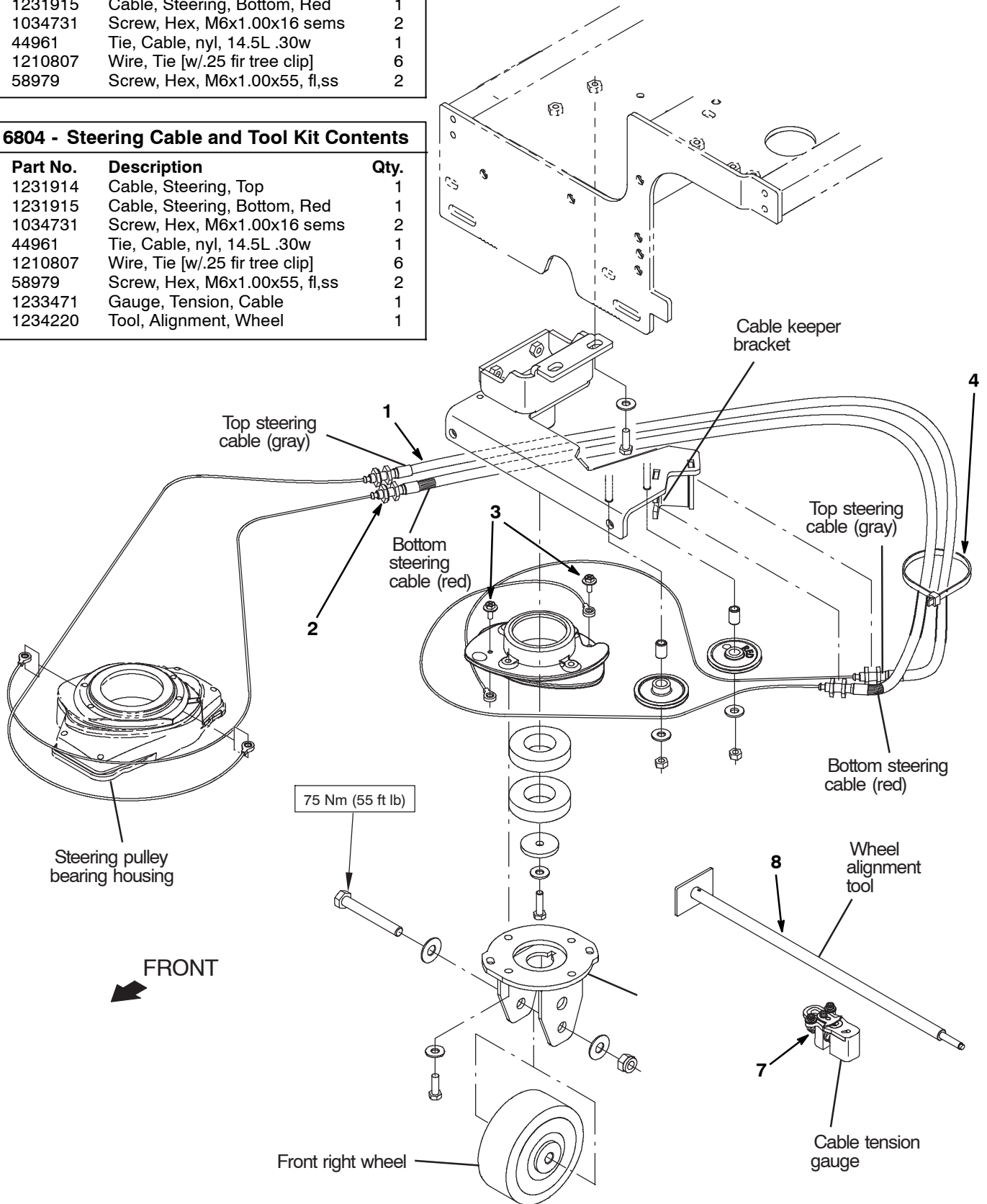

STEERING CABLE KIT: Continued

Refer to the Service Manual for steering cable installation instructions.

